

OVERVIEW

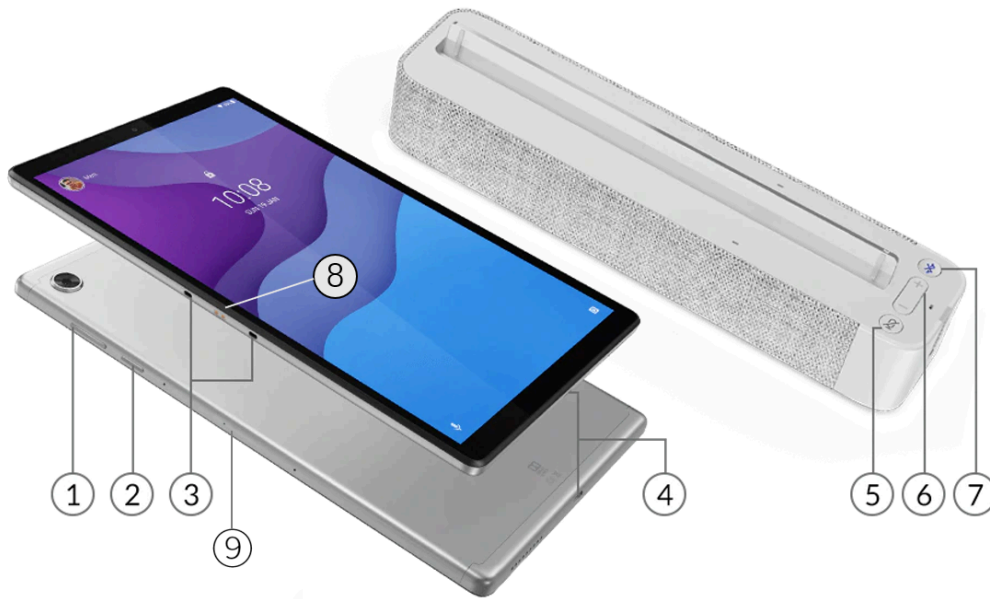

1. Volume button	6. Volume button
2. Power button	7. Bluetooth pairing button
3. Guide pins	8. Pogo pin connector (2-point)
4. USB-C 2.0	9. Card slot
5. Microphone mute button	

Notes:

- Card slot is for microSD card (WLAN model) or nano-SIM + microSD card (WWAN model)

PERFORMANCE

Processor

Processor Family

MediaTek Processor

Processor

Processor Name	Cores	Max Frequency	Processor Graphics
MediaTek Helio P22T	ARM Cortex A53 Octa-core	A53@2.3GHz / A53@1.8GHz	IMG PowerVR GE8320 GPU

Operating System

Operating System

Android™ 10

Graphics

Graphics

Graphics	Type	Memory
IMG PowerVR GE8320 GPU	Integrated	Shared

Chipset

Chipset

MediaTek SoC (System on Chip) platform

Memory

Max Memory

- 2GB soldered memory, not upgradable
- 3GB soldered memory, not upgradable
- 4GB soldered memory, not upgradable

Memory Type

LPDDR4x

Storage

Storage Support

- 32GB eMCP4x on systemboard
- 64GB eMCP4x on systemboard
- microSD card, supports FAT32 up to 256GB, exFAT up to 1TB

Storage Type

Disk Type	Interface	Offering
Flash Memory	eMMC 5.1	32GB / 64GB

Removable Storage

Card Reader**

- Nano-SIM + microSD card slot (WWAN models)
- microSD card slot (WLAN models)

Multi-Media

Speakers

2 side speakers, optimized with Dolby® Atmos®

Microphone

Dual-microphone array (with dedicated DSP)

Camera

Front 5.0MP, fixed focus, face unlock, rear 8.0MP, autofocus

VoiceCall

- Voice call^[1]

- No support

Notes:

[1] Use of Voice call requires cellular data plan. Voice call functionality details may vary based on local operator network, data and messaging services. Please contact your carriers for details.

Sensor

Vibration Motor

Eccentric Rotating Mass (ERM)

Sensors

- Accelerometer (G) sensor
- Ambient light sensor (ALS)
- Hall sensor
- Proximity (P) sensor

Battery

Battery

Integrated Li-Polymer 5000mAh (minimum) / 5100mAh (typical)

Max Battery Life^[1]

Standby: 700 hr

Online video playback: 8 hr

Browsing: 10 hr

Charging Time^[2]

Over 4.5 hr to fully charged

Notes:

[1] All battery life claims are approximate and based on internal testing under optimal laboratory and network conditions. Actual battery performance will vary depending on numerous factors including product configuration and usage, software, operating conditions, wireless functionality, power management settings, screen brightness and other factors. The maximum capacity of the battery will naturally decrease with time and usage.

[2] Charging data claim is approximate and based on internal testing under optimal laboratory. Actual result may vary owing to differences in product configuration, usage, software, operating conditions and other factors.

Power Adapter

Power Adapter

5V/2A (10W) AC adapter, 100-240V, 50-60Hz

DESIGN

Display

Display^[1]

Size	Resolution	Touch	Type	Brightness	Surface	Aspect Ratio	Color Gamut	Key Features
10.1"	HD (1280x800)	Multi-touch	IPS	400nits	Anti-fingerprint	16:10	60% NTSC	TÜV Low Blue Light

Touchscreen

Capacitive-type multi-touch, supports 10-point touch

Notes:

[1] IPS (in-plane switching) technology may refer to IPS, PLS, ADS, AHVA, AAS.

Input Device

Pen

No support

Mechanical

Dimensions (WxDxH)^[1]

Tablet: 241.54 x 149.38 x 8.25 mm (9.50 x 5.88 x 0.32 inches)
Smart Dock: 65.5 x 283.6 x 50 mm (2.58 x 11.16 x 1.96 inches)

Weight^[2]

Tablet: around 420 g (0.93 lbs)
Smart Dock: 520 g (1.15 lbs)

Case Color**

- Iron grey
- Platinum grey

Case Material

Metal for back cover

Buttons

- Power button
- Volume button

Notes:

[1] The system dimensions may vary depending on configurations.

[2] The system weight is approximate and based on results in Lenovo® lab, which varies depending on the source of component, variance of the distribution of each component, and manufacturing process. It may not be the exact weight for each specific model.

CONNECTIVITY

Network

WLAN + Bluetooth®

802.11a/b/g/n/ac dual band 1x1 Wi-Fi® + Bluetooth 5.0

WWAN

- 4G LTE
- No support

Cellular Bands

GSM: B2/B3/B5/B8
WCDMA: B1/B2/B5(B6/B19)/B8
FDD LTE: B1/B2/B3/B4/B5(B19)/B7/B8/B20/B28(a+b)
TDD LTE: B38/B40

Wi-Fi Direct

Support

Wi-Fi Display

Support

FM Radio

FM Radio

Location Services**

Models	Location
WLAN models	GPS + GLONASS
WWAN models	GPS + GLONASS + A-GPS

Ports^[1]

Standard Ports

- 1x Card slot
- 1x Headphone / microphone combo jack (3.5mm)
- 1x Pogo pin connector (2-point)
- 1x USB-C® 2.0 (support data transfer and charging)

Notes:

[1] The transfer speed of following ports will vary and, depending on many factors, such as the processing speed of the host device, file attributes and other factors related to system configuration and your operating environment, will be

slower than theoretical speed.

USB 2.0: 480 Mbit/s;

USB 3.2 Gen 1 (SuperSpeed USB 5Gbps, formerly USB 3.0 / USB 3.1 Gen 1): 5 Gbit/s;

USB 3.2 Gen 2 (SuperSpeed USB 10Gbps, formerly USB 3.1 Gen 2): 10 Gbit/s;

USB4® 20Gbps / USB 3.2 Gen 2x2 (SuperSpeed USB 20Gbps): 20 Gbit/s;

USB4 40Gbps (USB 40Gbps): 40 Gbit/s;

Thunderbolt™ 3/4: 40 Gbit/s.

SERVICE

Warranty

Base Warranty**^[1]

- 1-year carry-in service
- 1-year mail-in service
- 1-year courier service
- 1-year Customer Replaceable Unit (CRU) service
- 2-year (1-yr battery) courier service

Notes:

^[1] For warranty upgrade service, please go to <https://smartfind.lenovo.com/services>. To learn more details of warranty policy, please access <https://pcsupport.lenovo.com/warranty>.

ENVIRONMENTAL

Operating Environment

Temperature

Operating: 0°C (32°F) to 40°C (104°F)

ACCESSORIES

Bundled Accessories

Bundled Accessories^[1]

Lenovo Smart Dock

Notes:

^[1] After finishing the steps of connecting and pairing (via bluetooth) the tablet to the dock, Alexa Show Mode will be on automatically when docked in next time and get charged simultaneously.

SOFTWARE

Preinstalled Software

Preinstalled Software^[1]

- Amazon Alexa-related Apps
- Bing Wallpaper
- Chrome
- Dolby Atmos
- Gmail
- Google
- Google Assistant
- Google Calendar
- Google Photos
- Messages (cellular device only)
- Phone by Google (cellular device only)
- YouTube Music

Notes:

^[1] Actual application availability varies by country/region.

CERTIFICATIONS

Green Certifications^[1]

Green Certifications^[2]

- (Optional) ENERGY STAR® 8.0
- RoHS compliant

Notes:

[1] The items listed under the "Green Certifications" section may not only refer to certification but also registration or self-declaration.

[2] ENERGY STAR 8.0 (TB-X306FA).

Other Certifications

Other Certifications

TÜV Rheinland® Low Blue Light (Software Solution)

- Feature with ** means that only one offering listed under the feature is configured on selected models.
- Lenovo reserves the right to change specifications or other product information without notice. Lenovo is not responsible for photographic or typographical errors. LENOVO PROVIDES THIS PUBLICATION "AS IS," WITHOUT WARRANTY OF ANY KIND, EITHER EXPRESS OR IMPLIED, INCLUDING THE IMPLIED WARRANTIES OF MERCHANTABILITY OR FITNESS FOR A PARTICULAR PURPOSE. Some jurisdictions do not allow disclaimer of express or implied warranties in certain transactions, therefore this disclaimer may not apply to you.
- The specifications on this page may not be available in all regions, and may be changed or updated without notice.

